

XFrame Non-Load Bearing Wall Details (NZ)

Version: April 2022 | System: 8.26i (NZ)

Document Contents:

- 01. Cover & Contents
- 02. Standard 2.4m Panel Configuration
- 03. Standard 3.0m Panel Configuration
- 04. Generic 2.4m Wall Elevation
- 05. Wall to Floor Hold-Down
- 06. Wall to Ceiling Seismic Deflection Bracket
- 07. Wall to Structure Junction
- 08. Wall to Roof (Free-Standing).
- 09. Ceiling

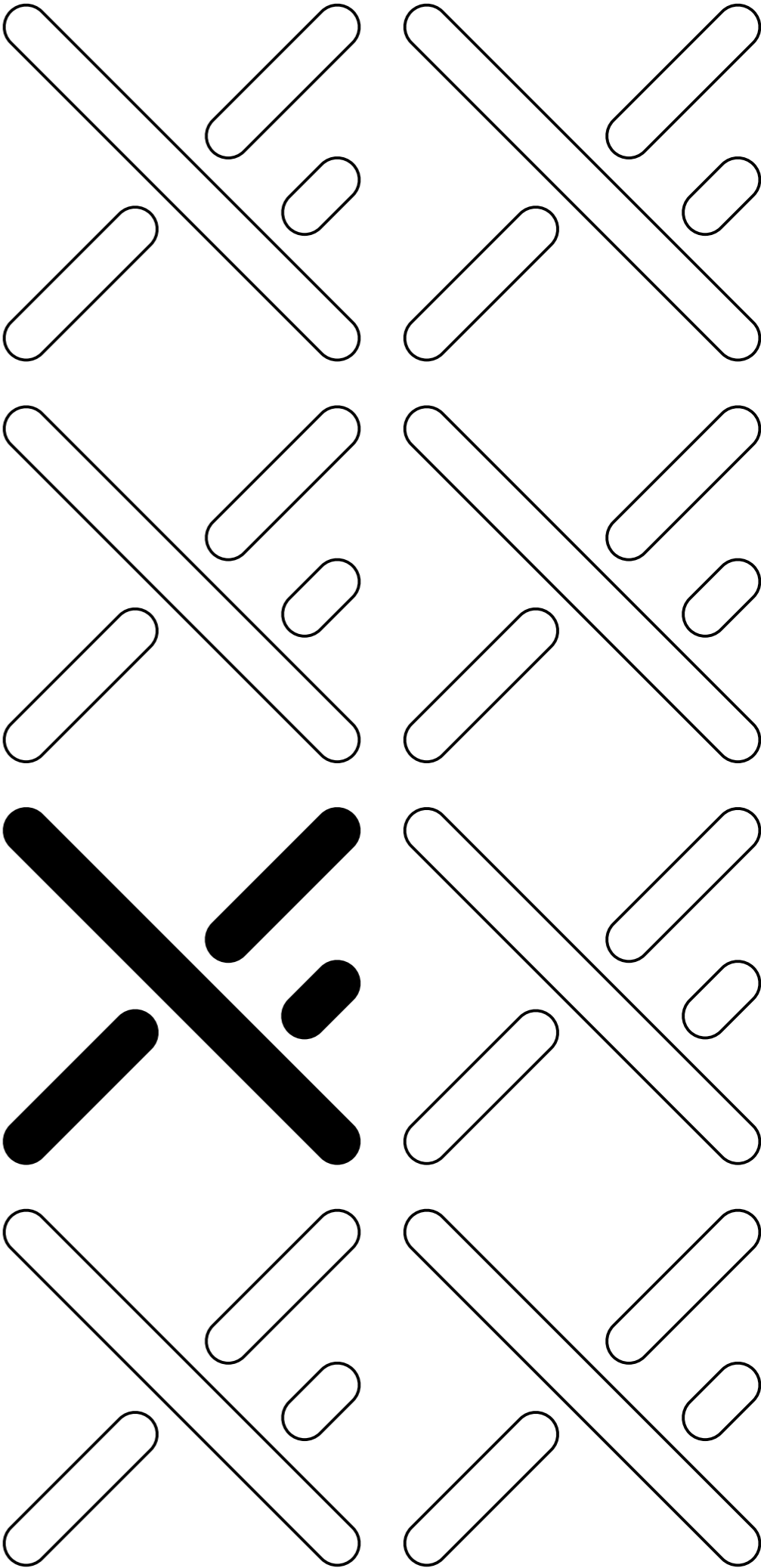

Frame Elevation

All locking plates and angular members are 12mm F8 structural pine plywood.

92mm Wall Thickness

2x 18mm + 2x 21mm ply members lapped @ 1200mm centers (min. 42mm x 67mm section).

110mm Wall Thickness

2x 18mm + 2x 21mm ply members lapped @ 1200mm centers (min. 42mm x 85mm section).

Green = 18mm F8 Structural Pine Plywood 'X-Stud'
Red = 21mm F8 Structural Pine Plywood 'Spline'

Green = 18mm F8 Structural Pine Plywood 'X-Stud'
Red = 21mm F8 Structural Pine Plywood 'Spline'

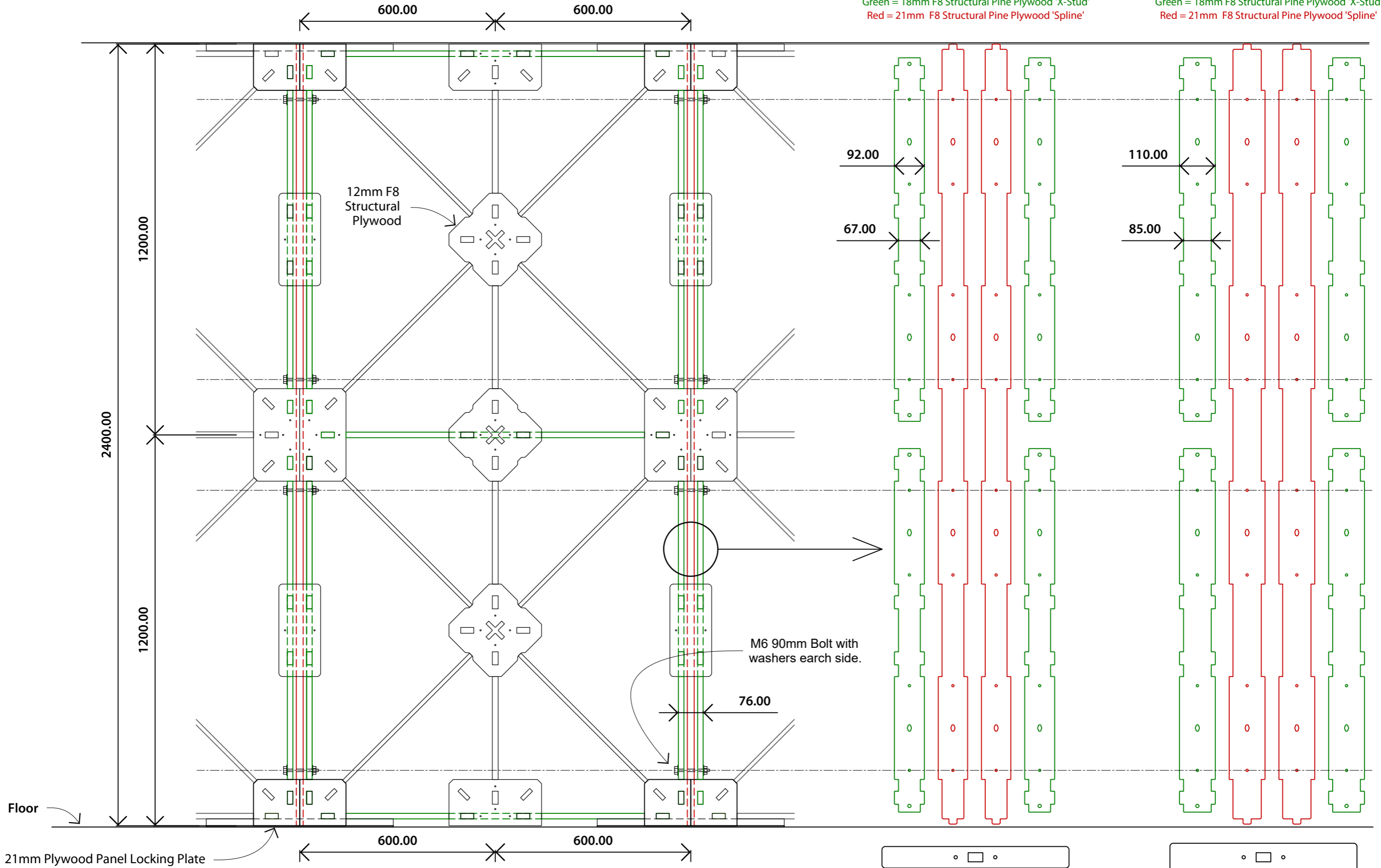

Frame Elevation

All locking plates and angular members are 12mm F8 structural pine plywood.

92mm Wall Thickness

2x 18mm + 2x 21mm ply members lapped @ 1200mm centers (min. 38mm x 67mm section).

Green = 18mm F8 Structural Pine Plywood 'X-Stud'
Red = 21mm F8 Structural Pine Plywood 'Spline'

110mm Wall Thickness

2x 18mm + 2x 21mm ply members lapped @ 1200mm centers (min. 36mm x 85mm section).

Green = 18mm F8 Structural Pine Plywood 'X-Stud'
Red = 21mm F8 Structural Pine Plywood 'Spline'

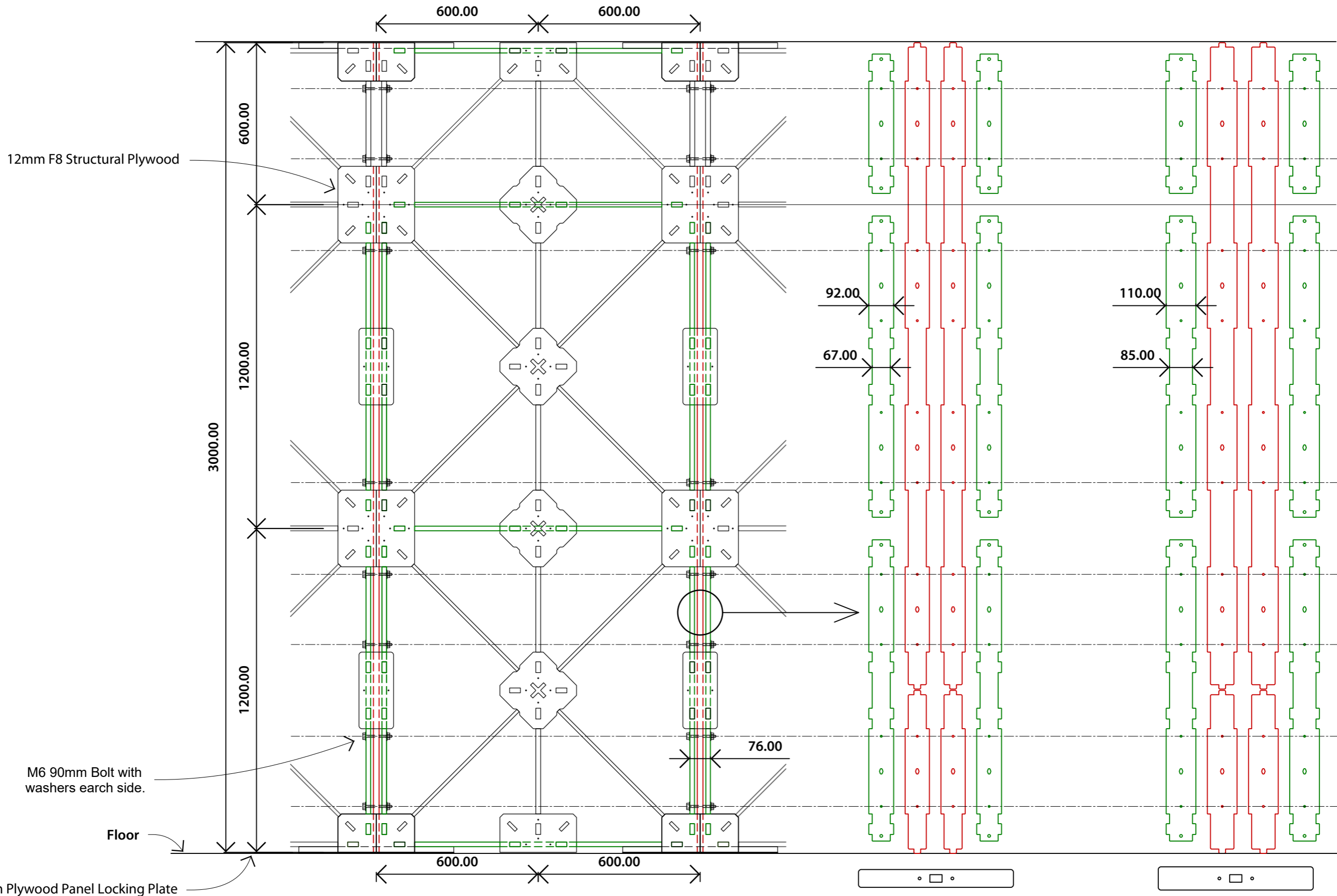

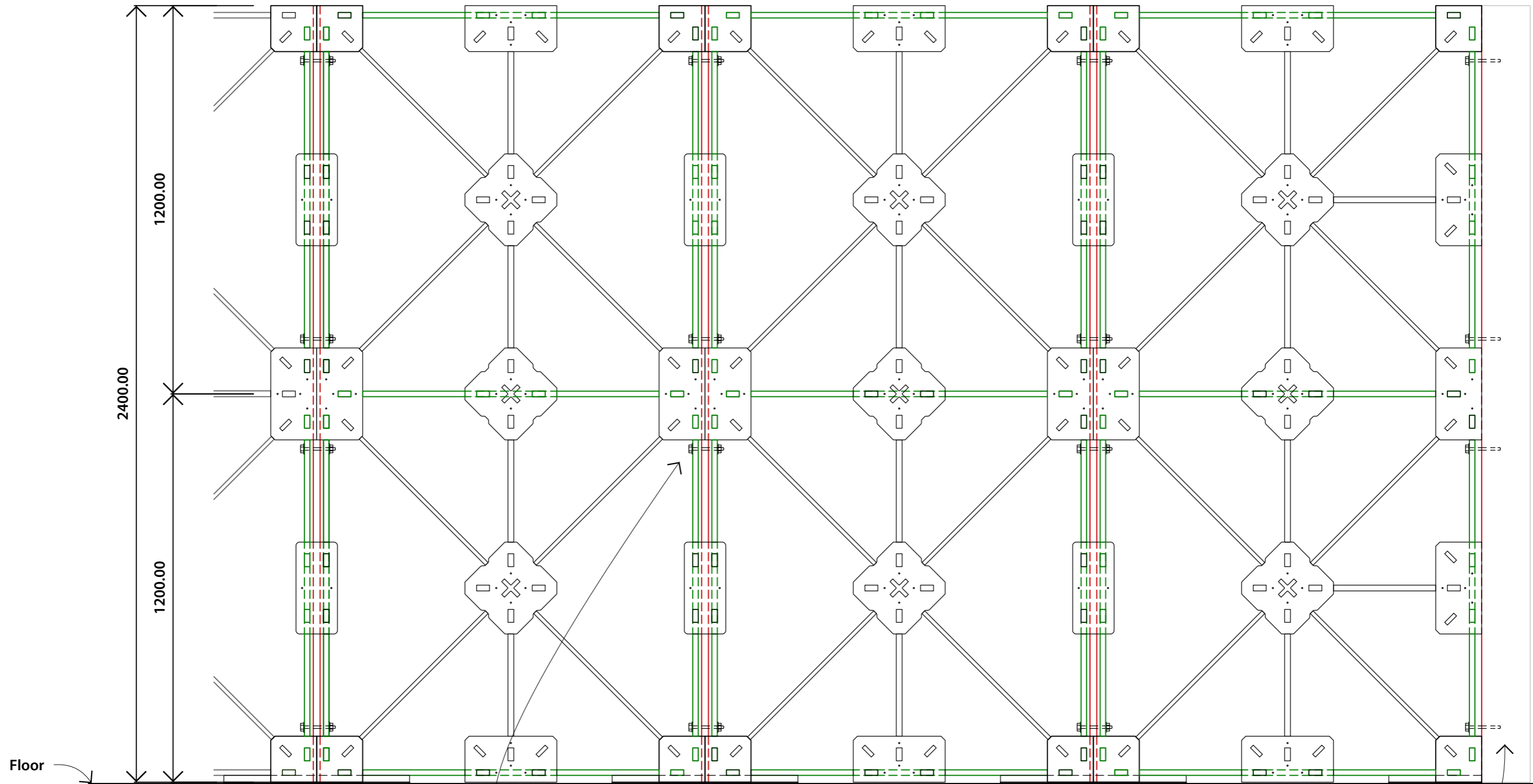
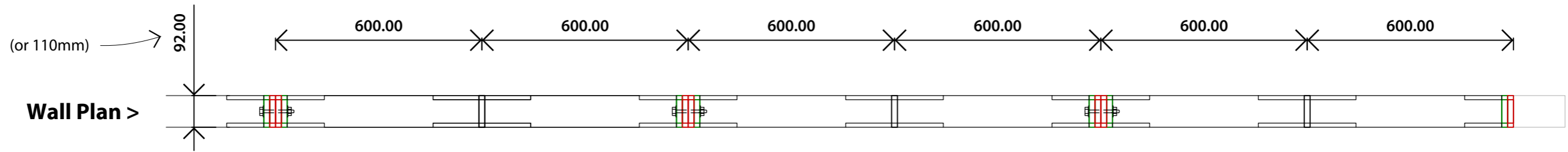

21mm Plywood Panel Locking Plate

M6 90mm Bolt with washers each side.

Wall end when abutting other structure.
Fixings to engineers specifications.

NOTE: Detail appropriate for NON-LOAD BEARING INTERNAL WALL ONLY. Check local requirements and confirm specification adequacy with project structural engineers.

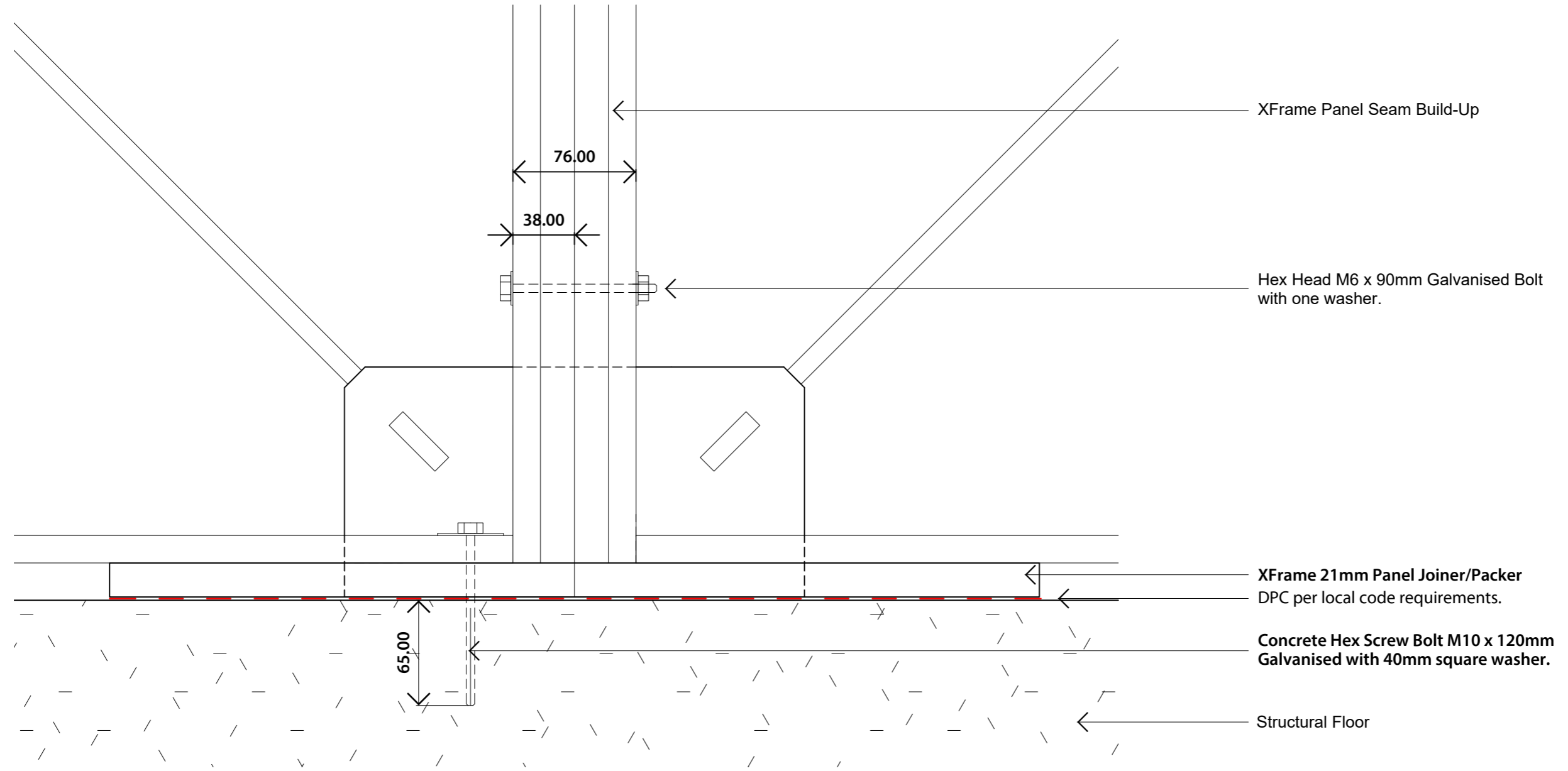

NOTE: Detail appropriate for NON-LOAD BEARING INTERNAL WALL ONLY. Check local requirements and confirm specification adequacy with project structural engineers.

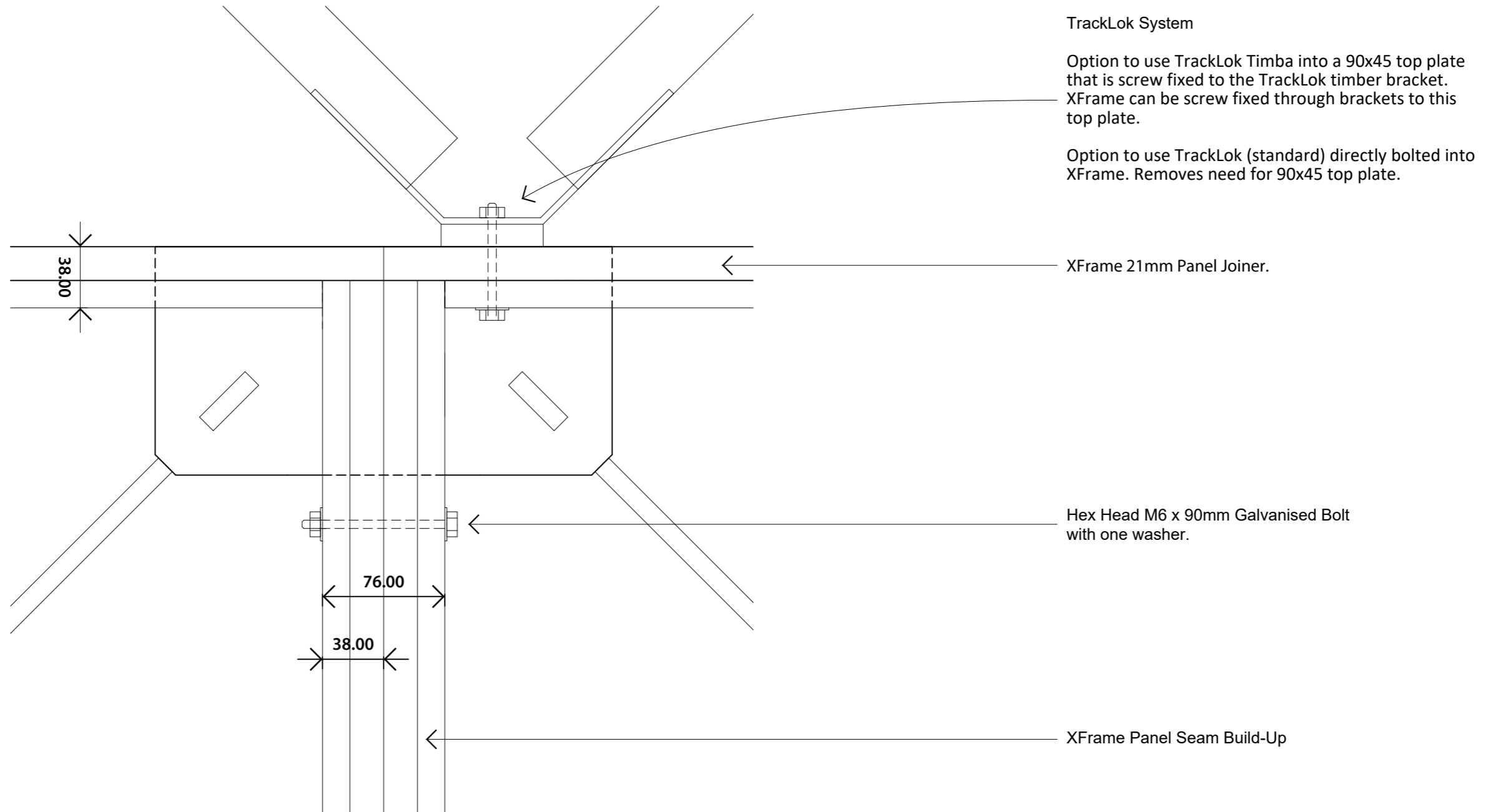

NOTE: Detail appropriate for NON-LOAD BEARING INTERNAL WALL ONLY. Check local requirements and confirm specification adequacy with project structural engineers.

Only suitable for 92mm wall thickness.

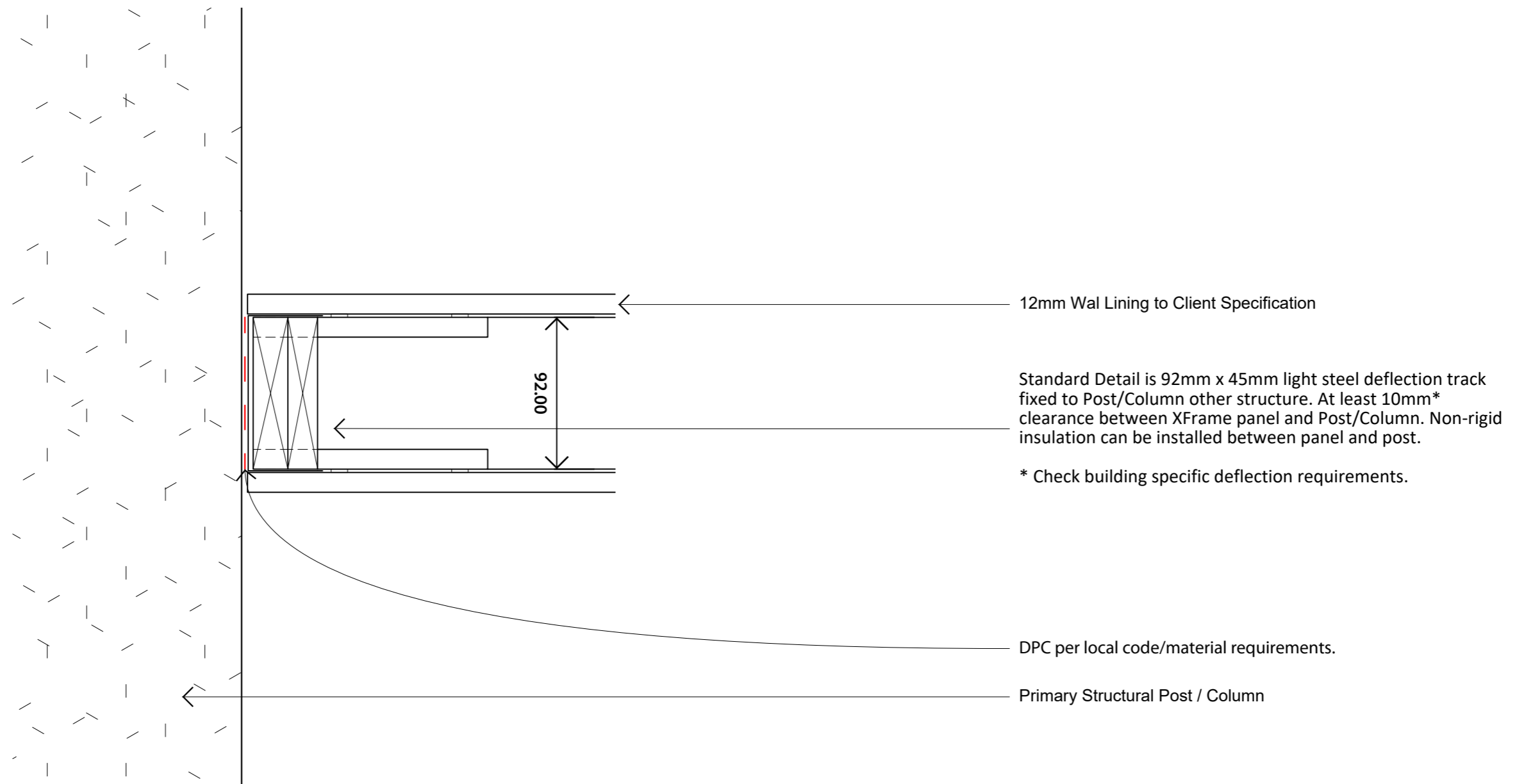

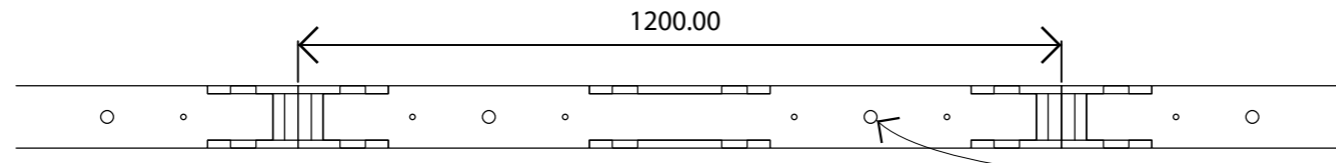

Frame Plan View

42mm wide LVL Rafter bolted to XFrame wall frame. Panels locked together via bolts and ceiling. No top plate required.

20mm diameter hole at 600mm centers for electrical pass-through vertically. Matching holes cut into brace members.

12mm XFrame Brace Member

'X-Stud' members extend to collect rafters. 2x 18mm plywood with 2x M10 100mm Bolts.

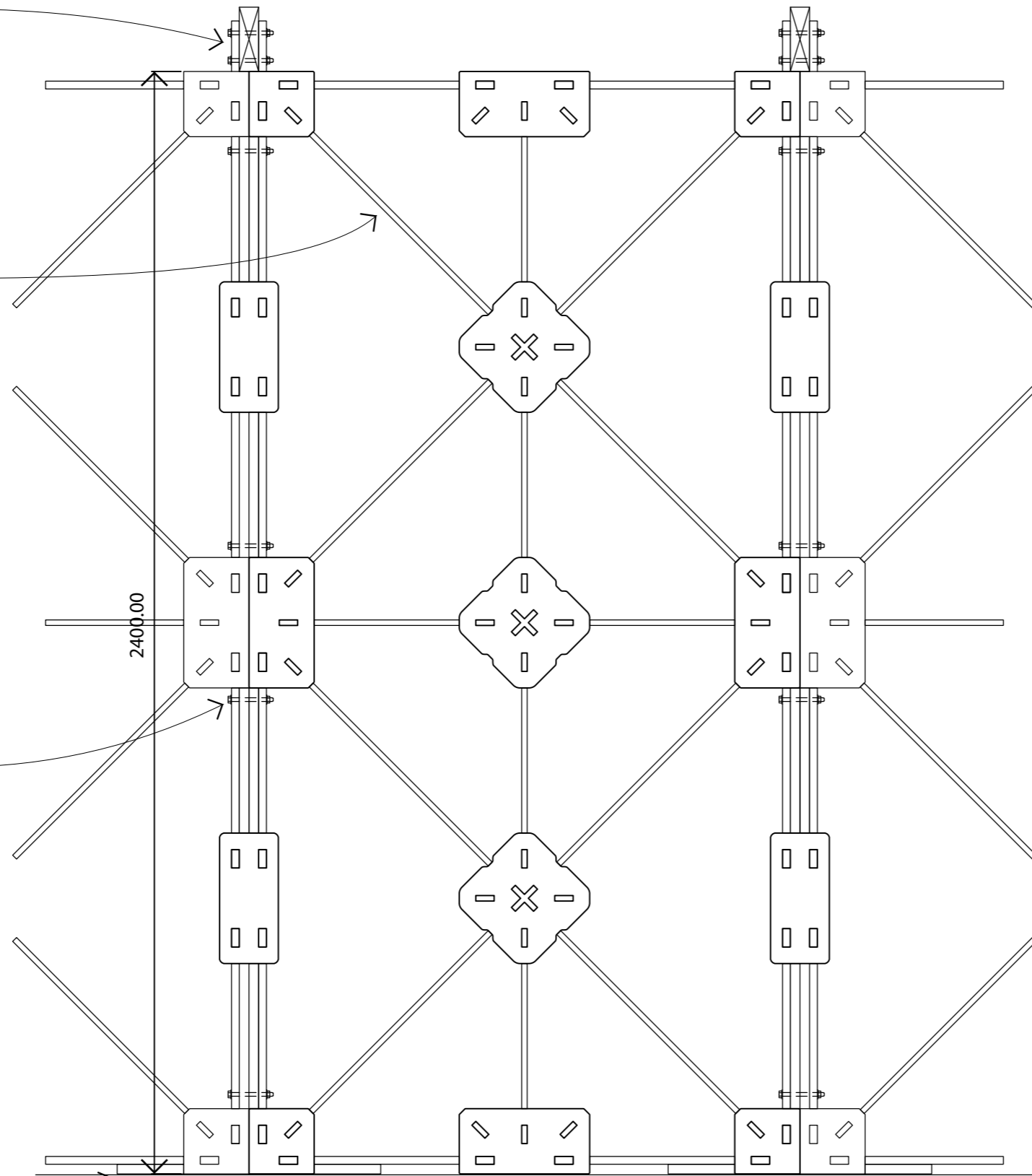

M8 90mm Bolt with washers each side.

12mm F8 Structural Plywood Member

21mm F8 Structural Plywood Member

21mm Plywood Panel Locking Plate

Front Frame Elevation

Frame Side/End Elevation



Drawing Name: 1.2mm x 2.4m Standard Panel with Roof Connection

Rectangular opening option for HVAC services.

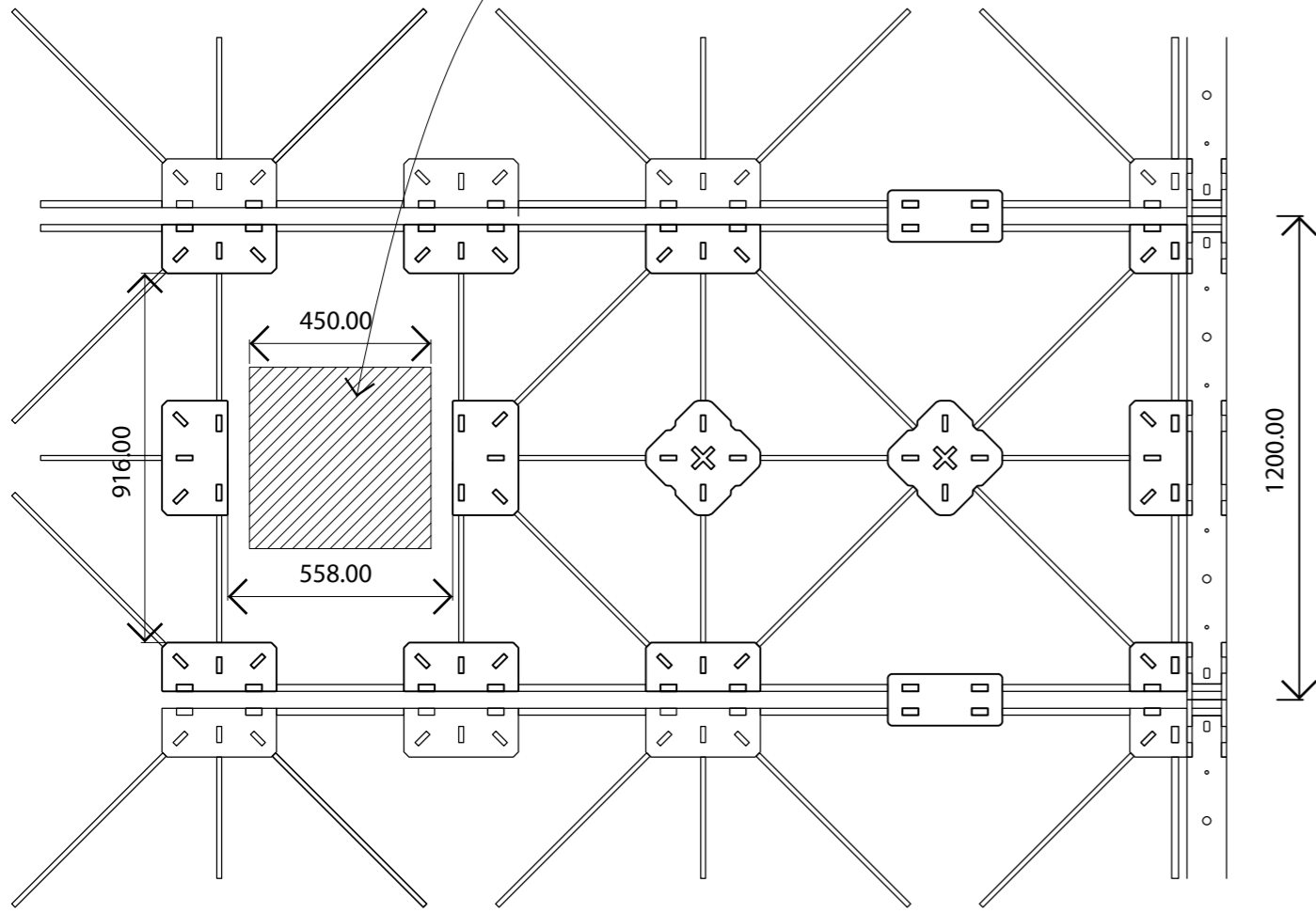

Ceiling Structure Plan

300mm diameter opening size for HVAC services

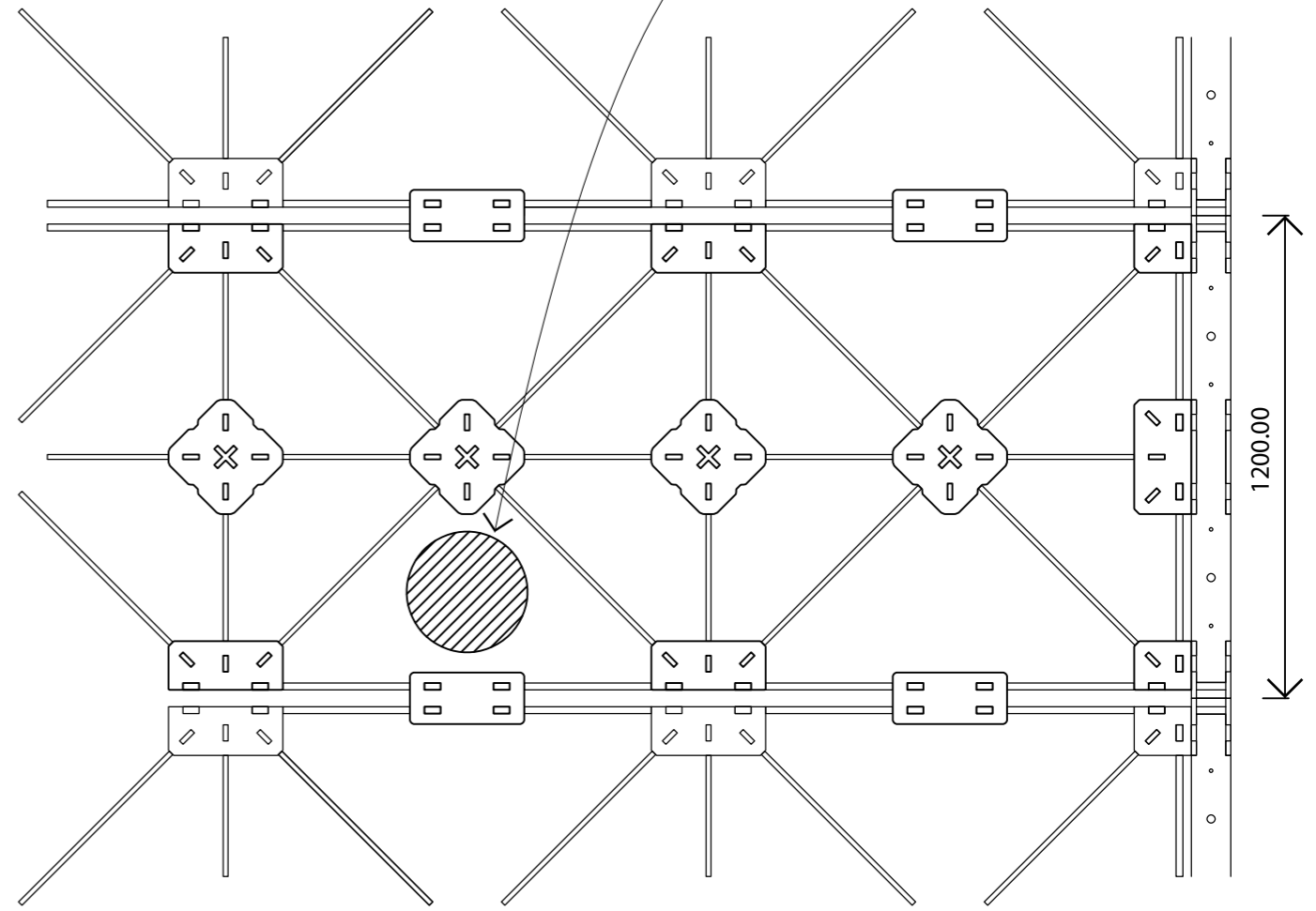

Ceiling Structure Plan

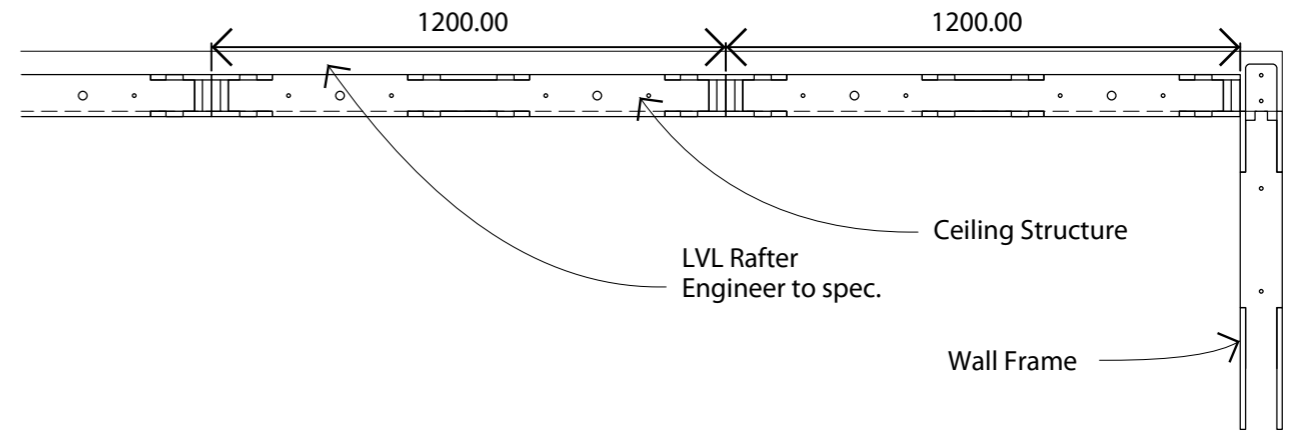

Elevation